

Total for the project		
ST-201	321 x 308 x 353	1

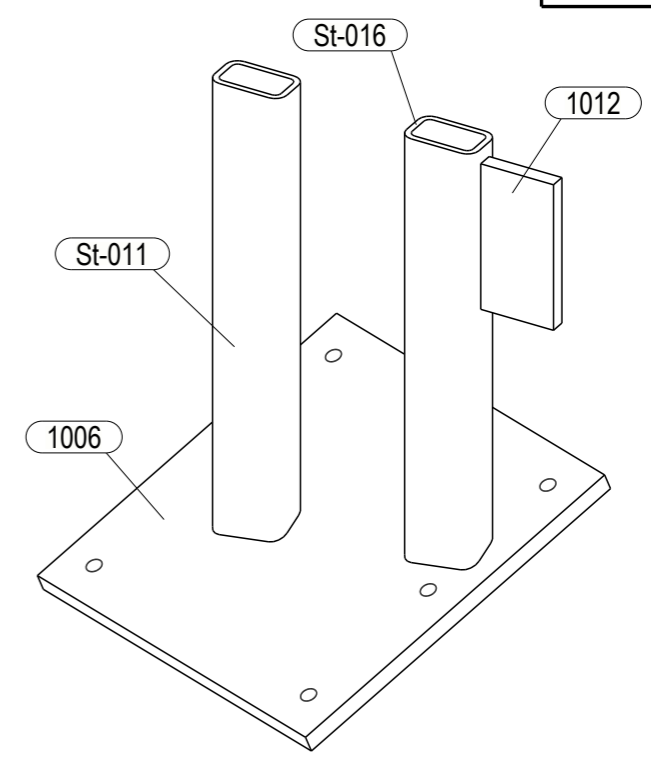

A - A
1:3

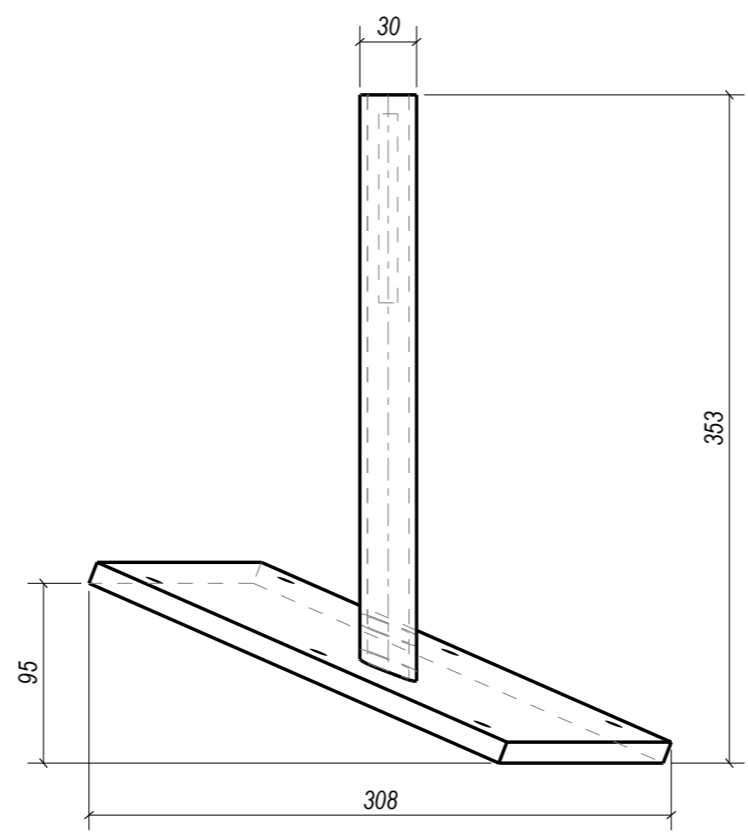
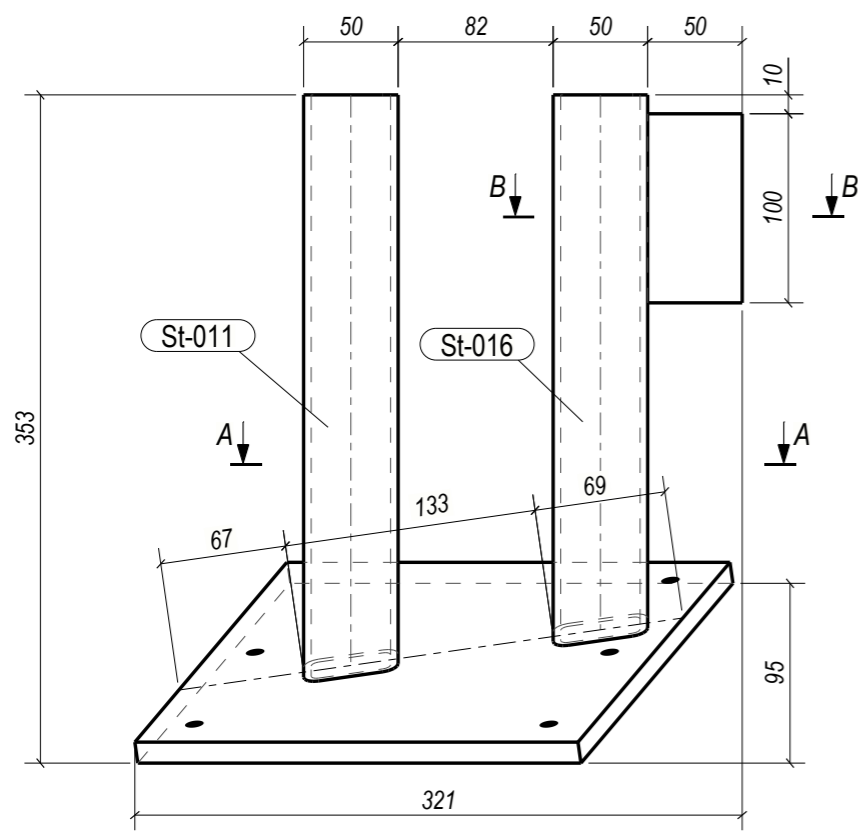
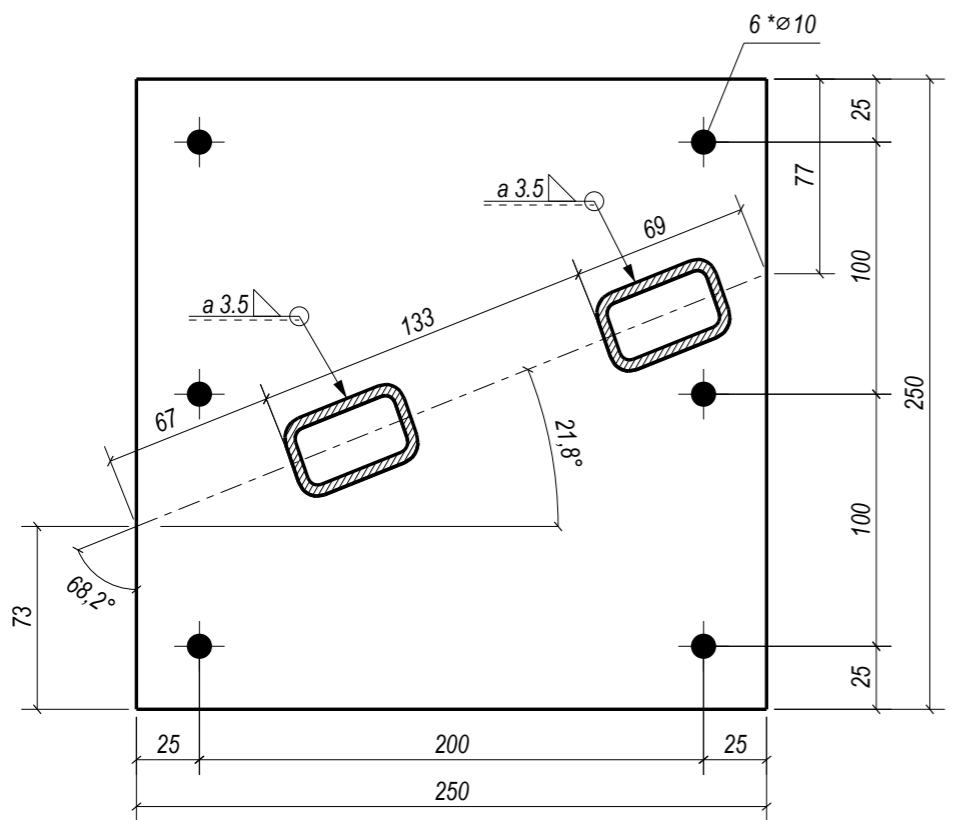

B - B
1:3

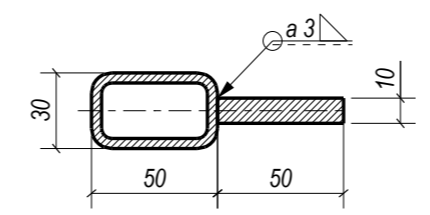

Technical requirements

Execution class:	EXC2	EN 1090-2
Tolerance class:	2	EN 1090-2
Welding class:	C	EN ISO 5817
Thermal cutting class:	442	EN ISO 9013
Preparation grade:	P2	EN ISO 8501-3
Surface treatment:	Sa2.5	EN ISO 8501-1
Corrosion class:	C1H EPPUR120/2	
Colour:	RAL9016	

SPECIFICATION

Part pos.	Qty.	Profile	Length, mm	Weight, kg	Weight total, kg	Steel	Note
1006	1	PL12*250	250	5.9	5.9	S355J2	
1012	1	PL10*50	100	0.4	0.4	S355J2	
St-011	1	CFRHS50X30X4	311	1.3	1.3	S355J2H	
St-016	1	CFRHS50X30X4	292	1.2	1.2	S355J2H	
				WELDS	1%	0.1	
TOTAL					8.9		

Object: **556.0S-ST-201**

Drawn		Customer:	8.9 kg	
Designed		SUPPORT	Stage	MKD
Checked			Page	Pages
Approved			1	1

Qty.	In assembly
1	ST-201

Workpiece
1:3

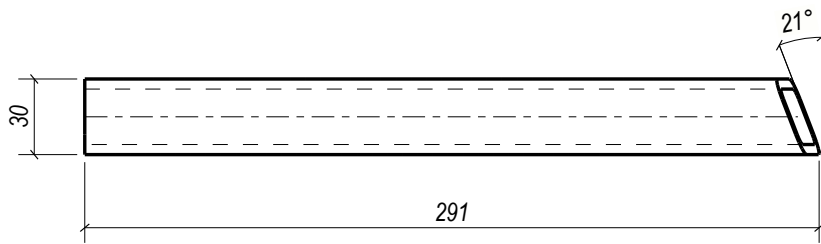
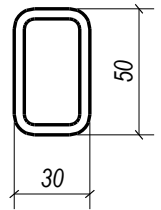
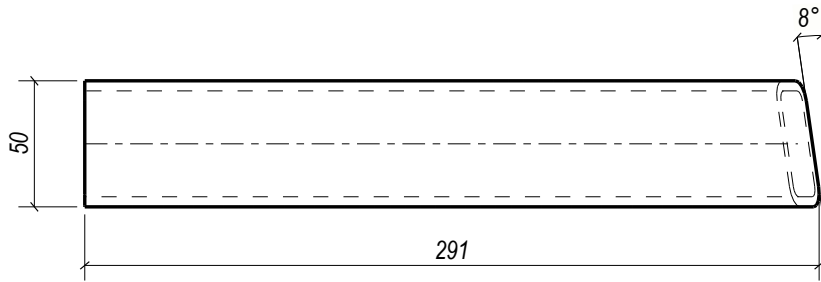
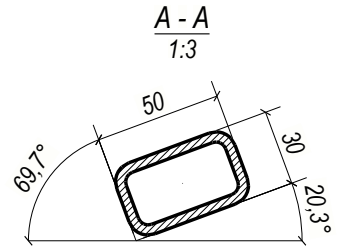
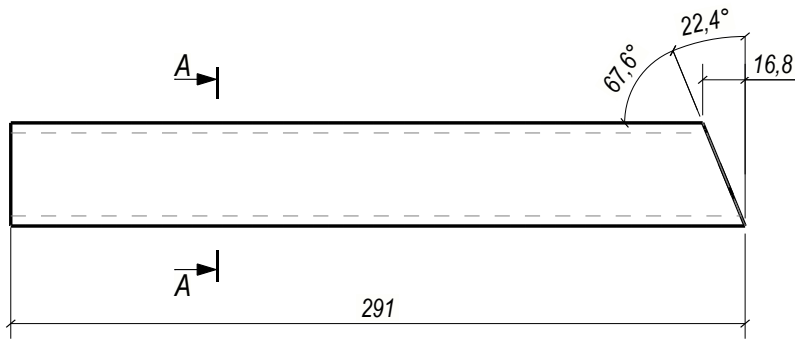

Material:		CFRHS50X30X4	Length = 292	Steel: S355J2H	Total: 1	
Object:					556.0S-St-016	
Drawn	I. Fomkins	Customer:			1.2 kg	
Designed		SUPPORT			Stage	MKD
Checked					Page	Pages
Approved					1	1

Format: A4